

Essential Banner Display

Product Parts

1. Banner stand
2. Snap Rails (x4)
3. Banner Graphic (x2)
4. Carry Case



Display Set-up

Step 1

Begin by removing all parts from the carry case and place on a clean, flat surface.

Step 2

Assemble the Shock-Corded Poles by placing the tapered end of one pole into the large end of the next.

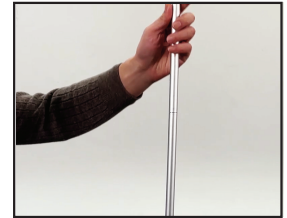
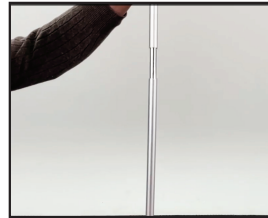

Step 3

Turn legs on the Banner Stand (1) counter-clockwise until they lock into place.



Step 4

On a clean flat surface, lay Banner Graphic (3) flat. Remove the endcaps and open the Snap Rail (2).

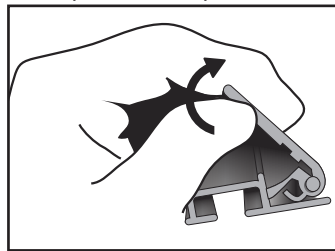

Open Snap Rail

Step 5

With Graphic (3) face side up, fully insert top edge into the groove of the Snap Rail (2) press to close, running along the full length of the Snap Rail (2) to ensure full closure. Repeat for bottom Snap Rail (2). Align and press each end cap into the ends of each Snap Rail (2).

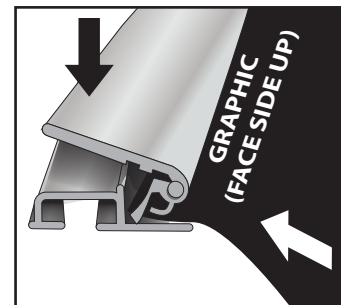

Insert Graphic then snap shut

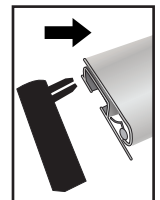

Insert End Cap

Step 6

Starting with the Snap Rail (2) located on the top of your banner, align the Snap Rail's groove with the clip at the top of the pole and attach. Unlock the bottom Snap Rail clip on the pole and adjust the height until the bottom Snap Rail (2) can be easily attached to the clip and lock in place. Repeat this step for second Banner Graphic (3).

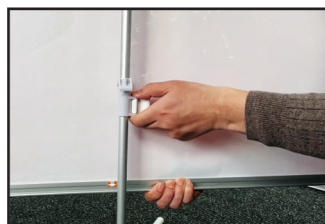

Note: There is a spring in the pole to help place the second banner on the clip. Adjust the lower clip if necessary to make sure the banner is smooth and taut.



Storage & Care

Place all product parts into Carry Case and store in a cool dry location. To clean non-graphic hardware, wipe with a damp cloth.